

Submittal Data

System: E12SD3UAW

Single Zone Heat Pump Ceiling Concealed

Job Name: _____
 Location: _____
 Engineer: _____
 Submitted to: _____
 Submitted by: _____
 Reference: _____
 Approval: _____
 Date: _____
 Construction: _____
 Unit#: _____
 Drawing#: _____



CS-E12SD3UAW

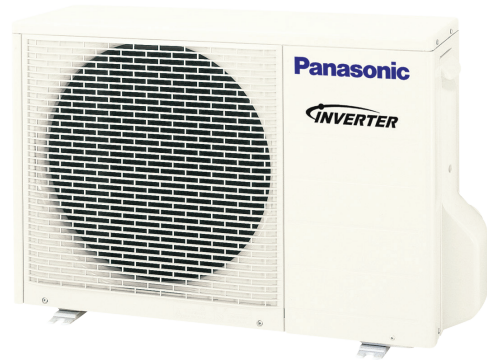

CU-E12SD3UA

OUTDOOR UNIT DIMENSIONS

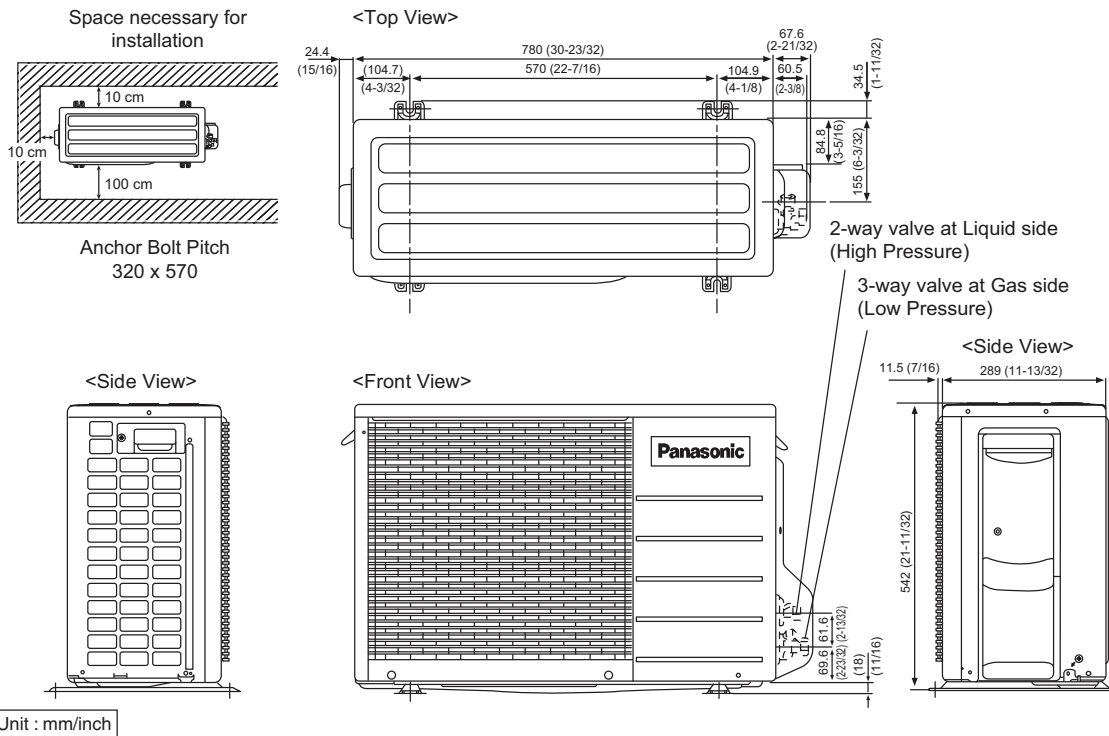

INDOOR UNIT DIMENSIONS

<Front View>

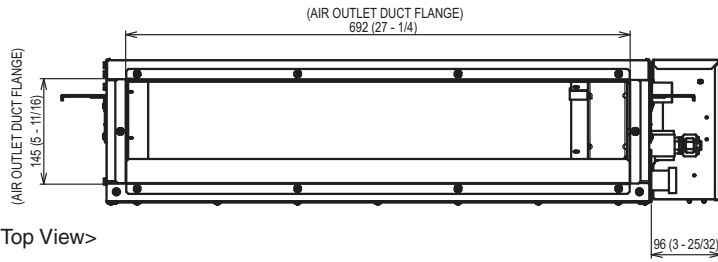

<Top View>

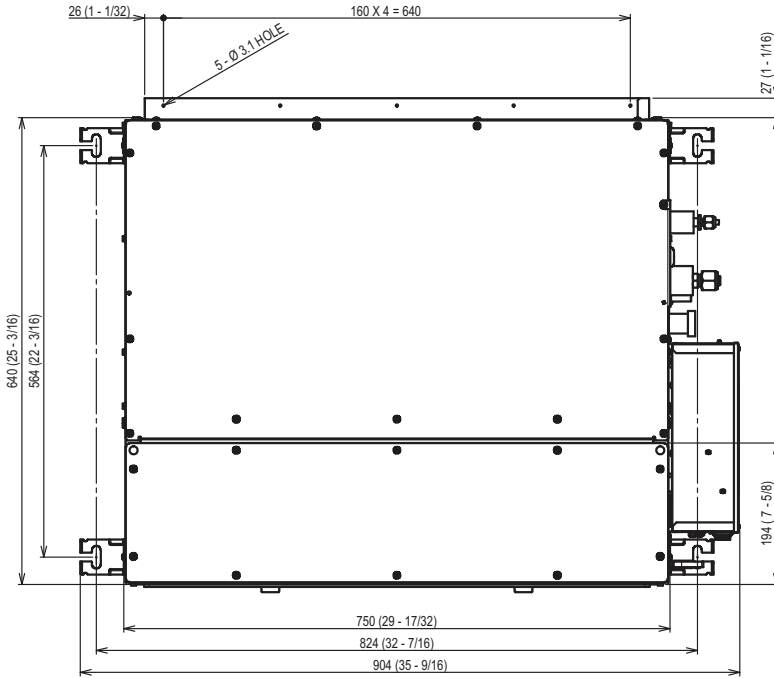

<Side View>

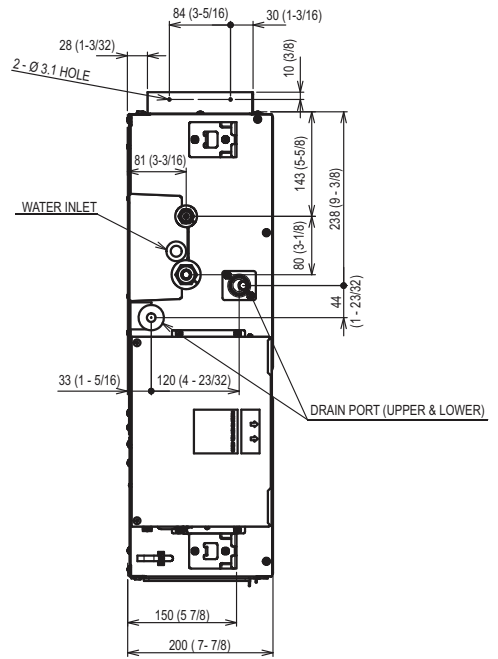

<Back View>

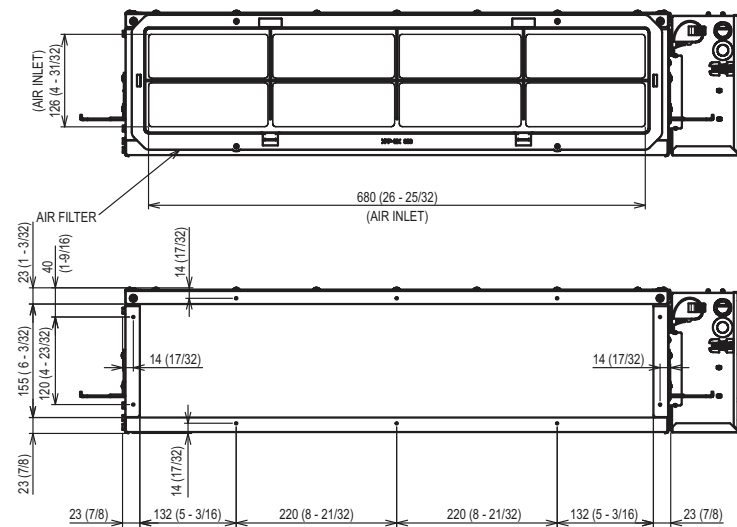

<Remote Control>

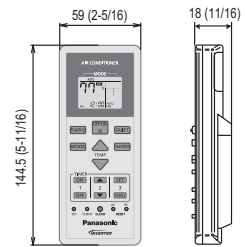

<Remote Control Holder>

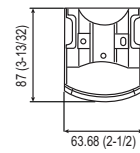

Unit : mm/inch

General Data	
Power (V/P/Hz)	230/208/1/60
Circuit Ampacity (A)	15
Fuse Size, Max.(A)	15
Compressor	
	DC Twin Rotary (Inverter)
No. Used	1
Motor Type (No. of poles)	DC Brushless (4 poles)
Output Power (W)	700
Outdoor Unit	
Fan Type	Propeller
No. Speeds	Variable speed
Type Drive	Direct / DC Motor
No. Poles (RPM)	8/820
No. Motors (W)	1/40
CFM (Hi speed)	1,100
Coil Type	Aluminum Fin Blue Coated
Fin Type - Pipe Type	Corrugated Fin
Rows x stage x F.P.I.	2 x 24 x 17
Size (W x H x L) mm	36.4 x 504 x 824
Indoor Unit	
Fan Type	Cross Flow
Motor Type, No. of Poles	DC Brushless 8 poles
No. Speeds	5
RPM (Cool / Heat), High	1
No. Motors (W)	1-51
CFM (Qlo/Lo/Me/Hi/SHi) Cooling	328/350/413/475/523
CFM (Qlo/Lo/Me/Hi/SHi) Heating	300/328/403/475/523
Operating Sound-H/L/QLo/ dB-A (Cool)	35/28/25
Operating Sound-H/L/QLo/ dB-A (Heat)	35/28/25
Max External Static Pressure	0.22 WG
Coil Type	Aluminum (Pre Coat)
Fin Type	Slit Fin
Row x stage x FPI	3 x 12 x 18
Size mm	590 x 282 x 38.1
Drain Connection Size Inner Diameter (in.)	5/8
Refrigerant	
	R410A
OZ. - R410a (outdoor unit)	38.1
Refrigerant Control	Electronic Expansion Valve
Refrigerant Tubing Connections	Flare
Line Length, Max (ft.)	65.6
Elevation Difference, Max (ft.)	49.2
Line Size (in. O.D. Discharge)	1/4"
Line Size (in. O.D. Suction)	1/2"
Pre-charge, tubing length at shipment	24.6'

Dimensions (HxWxD)			
Indoor Unit (Uncrated) (in.)	7-7/8 X 29-17/32 X 25-7/32		
Outdoor Unit (Uncrated) (in.)	21-11/32 X 30-23/32 X 11-13/32		
Weight (lbs.)			
(Indoor) Net	42lb		
(Outdoor) Net	82lb		
Performance Data @ ARI Standard Conditions			
High Heating @47° (BTU/H)	NA		
Low Heating @17° (BTU/H)	NA		
Cooling			
Total Capacity (BTU/H)	11,500(4,100 - 13,300)		
Sensible Capacity (BTU/H)	12,109		
Latent Capacity (BTU/H)	1,198		
SEER	20.00		
Dehumidification (Pints/H)	1.7		
Amps (A)	4.2		
Power Input (W)	920		
Outdoor Sound Rating (dB-A)	49		
Heating			
Total Capacity (BTU/H)	13,800 (4,100-16,300)		
HSPF	10.00		
Amps (A)	5.6		
Power Input (W)	1.25K		
Outdoor Sounds Rating (dB-A)	51		
Features			
Controls	Microprocessor		
Remote Controller	Wireless With Receiver Included		
Wired Remote Controller	Optional		
Temperature Control	IC Thermistor		
Timer	Single Event Daily ON/OFF TIMER		
Quiet mode	Included		
High Power mode	Included		
Air Louver, Horizontal	NA		
Air Louver, Vertical	NA		
Power Failure Automatic Restart	Built-In		
Heating/Cooling Automatic Changeover	Built-In		
Self-Diagnosis	Built-In		
Air Filter	Washable		
Operating Range	Indoor Air Intake Temp	Outdoor Air Intake Temp	
Cooling	Max	89.6F DB / 73.4F WB	114.8F DB / 78.8WB
	Min	60.8F DB / 51.8F WB	0F DB / -/-
Heating	Max	86.0F DB	75.2F DB / 64.4F WB
	Min	60.8DB	-4.0F DB/-5.8F WB

