

Submittal Data

System: E9SD3UAW

Single Zone Heat Pump Ceiling Concealed

Job Name: _____
 Location: _____
 Engineer: _____
 Submitted to: _____
 Submitted by: _____
 Reference: _____
 Approval: _____
 Date: _____
 Construction: _____
 Unit#: _____
 Drawing#: _____



CS-E9SD3UAW



CU-E9SDUA

OUTDOOR UNIT DIMENSIONS

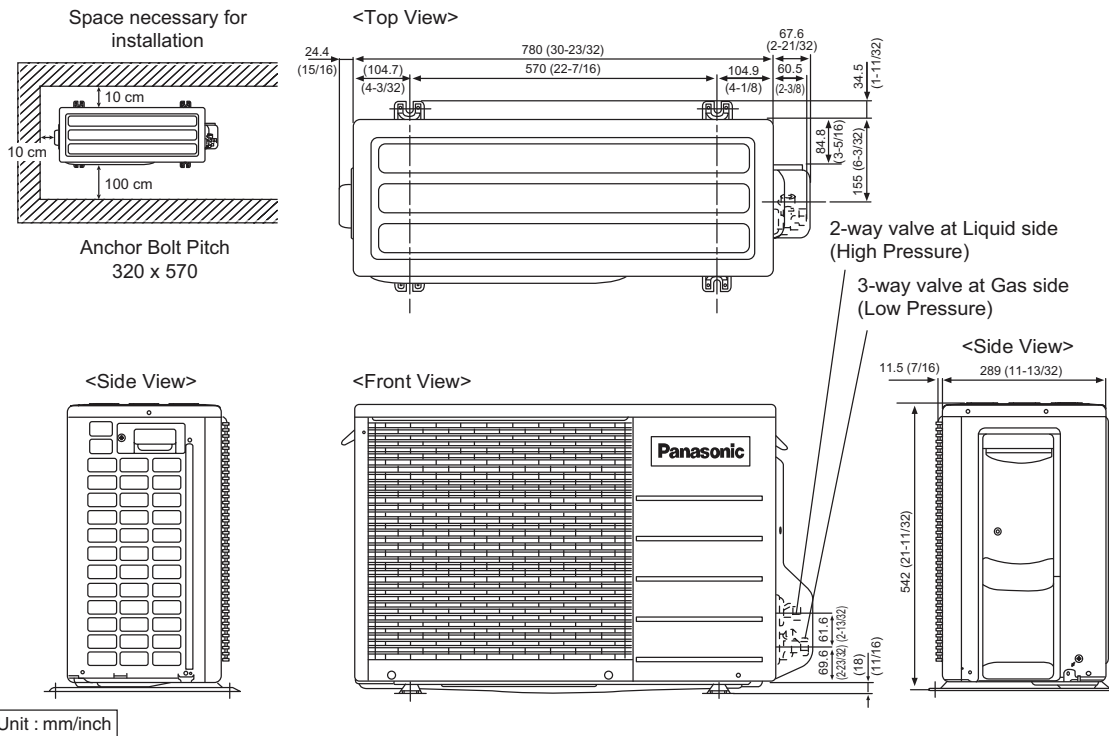

INDOOR UNIT DIMENSIONS

<Front View>

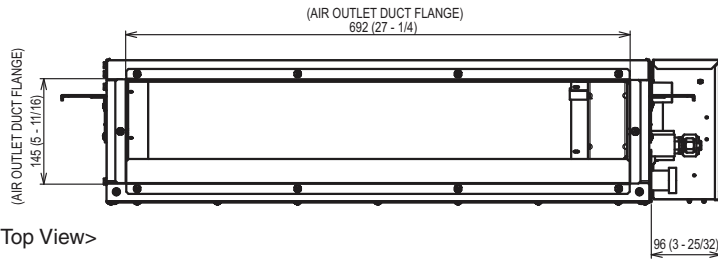

<Top View>

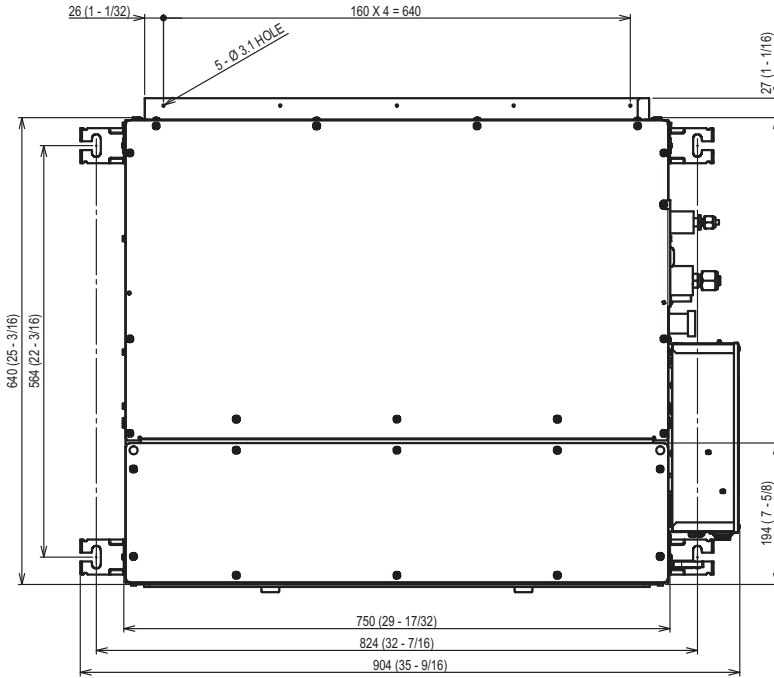

<Side View>

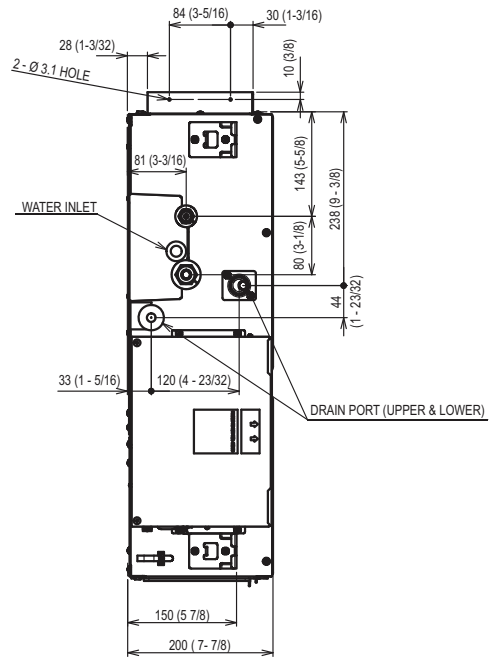

<Back View>

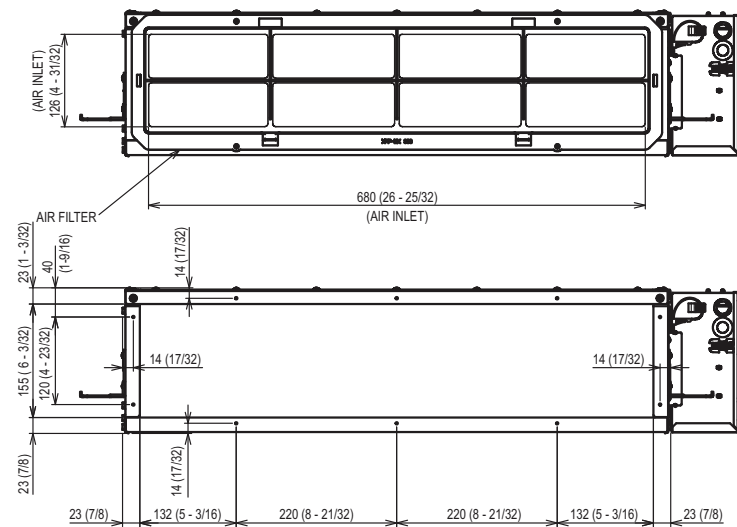

<Remote Control>

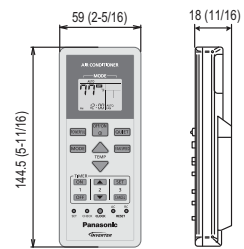

<Remote Control Holder>

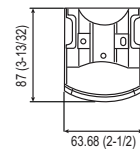

Unit : mm/inch

General Data	
Power (V/P/Hz)	230/208/1/60
Circuit Ampacity (A)	15
Fuse Size, Max.(A)	15
Compressor	
	DC Twin Rotary (Inverter)
No. Used	1
Motor Type (No. of poles)	DC Brushless (4 poles)
Output Power (W)	700
Outdoor Unit	
Fan Type	Propeller
No. Speeds	Variable speed
Type Drive	Direct / DC Motor
No. Poles (RPM)	8/830
No. Motors (W)	1/40
CFM (Hi speed)	1,095
Coil Type	Aluminum Fin Blue Coated
Fin Type - Pipe Type	Corrugated Fin
Rows x stage x F.P.I.	2 x 24 x 17
Size (W x H x L) mm	36.4 x 504 x 713
Indoor Unit	
Fan Type	Sirocco
Motor Type, No. of Poles	DC 8 poles
No. Speeds	5
RPM (Cool / Heat), High	1280
No. Motors (W)	1/51
CFM (Qlo/Lo/Me/Hi/SHi) Cooling	328/350/413/475/505
CFM (Qlo/Lo/Me/Hi/SHi) Heating	300/328/403/475/505
Operating Sound-H/L/QLo/ dB-A (Cool)	35/28/25
Operating Sound-H/L/QLo/ dB-A (Heat)	35/28/25
Max External Static Pressure	0.22 WG
Coil Type	Aluminum (Pre Coat)
Fin Type	Slit Fin
Row x stage x FPI	3 x 12 x 18
Size mm	590 x 282 x 38.1
Drain Connection Size Inner Diameter (in.)	5/8
Refrigerant	
	R410A
OZ. - R410a (outdoor unit)	34.6
Refrigerant Control	Electronic Expansion Valve
Refrigerant Tubing Connections	Flare
Line Length, Max (ft.)	65.6
Elevation Difference, Max (ft.)	49.2
Line Size (in. O.D. Discharge)	1/4"
Line Size (in. O.D. Suction)	3/8"
Pre-charge, tubing length at shipment	24.6'

Dimensions (HxWxD)		
Indoor Unit (Uncrated) (in.)	7-7/8 X 29-17/32 X 25-7/32	
Outdoor Unit (Uncrated) (in.)	21-11/32 X 30-23/32 X 11-13/32	
Weight (lbs.)		
(Indoor) Net	42lb	
(Outdoor) Net	82lb	
Performance Data @ ARI Standard Conditions		
High Heating @47° (BTU/H)	NA	
Low Heating @17° (BTU/H)	NA	
Cooling		
Total Capacity (BTU/H)	9,000(4,100 - 10,200)	
Sensible Capacity (BTU/H)	9,417	
Latent Capacity (BTU/H)	819	
SEER	20.50	
Dehumidification (Pints/H)	1.3	
Amps (A)	3.2	
Power Input (W)	690	
Outdoor Sound Rating (dB-A)	50	
Heating		
Total Capacity (BTU/H)	12,000 (4,100-14,100)	
HSPF	10.00	
Amps (A)	5.1	
Power Input (W)	1.12K	
Outdoor Sounds Rating (dB-A)	50	
Features		
Controls	Microprocessor	
Remote Controller	Wireless With Receiver Included	
Wired Remote Controller	Optional	
Temperature Control	IC Thermistor	
Timer	Single Event Daily ON/OFF TIMER	
Quiet mode	Included	
High Power mode	Included	
Air Louver, Horizontal	NA	
Air Louver, Vertical	NA	
Power Failure Automatic Restart	Built-In	
Heating/Cooling Automatic Changeover	Built-In	
Self-Diagnosis	Built-In	
Air Filter	Washable	
Operating Range	Indoor Air Intake Temp	Outdoor Air Intake Temp
Cooling	Max	89.6F DB / 73.4F WB
	Min	60.8F DB / 51.8F WB
Heating	Max	86.0F DB
	Min	60.8DB
		114.8F DB / 78.8WB
		0F DB / -/-
		75.2F DB / 64.4F WB
		-4.0F DB/-5.8F WB

